



PIV NRS Flanged Gate Valve BS5163 Fig. 114.1FF / 114.2FF

Product Description

Rapidrop Fig.114FF Valve is a manually operated, non rising stem resilient wedge gate valve designed for use in fire protection systems for on/off operation only. The lightweight ductile iron body allows for easier handling and reduced shipping costs. Valves are suitable for both vertical and horizontal installation. Rapidrop Fig.110 vertical post indicator and Rapidrop Fig.111 wall post indicator, are available separately.

Valve components are corrosion resistant or coated with a thermally applied fusion-bonded epoxy. The EPDM encapsulated ductile iron wedge with a compression mechanism is designed to achieve water tight sealing and low torque operation.

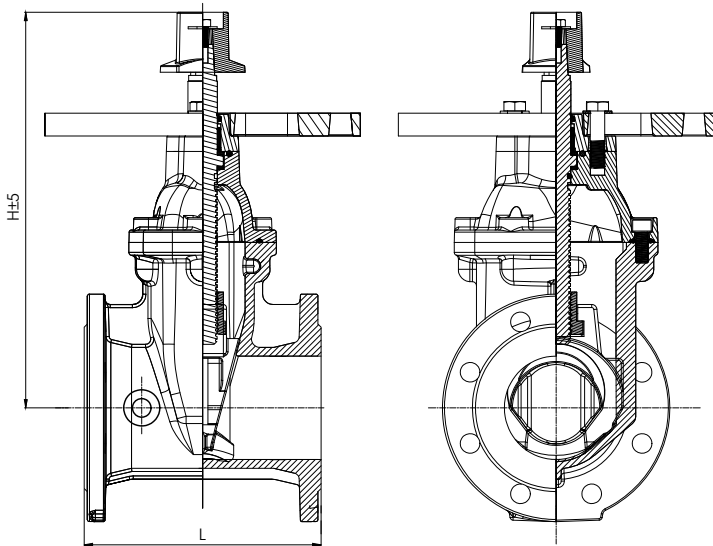

Maximum Working Pressure

UL: Figure 114.1 (4" - 8") : 20.7 bar (300 PSI)

Figure 114.2 (10" - 12") : 17.2 bar (250 PSI)

FM: 16 bar (232 PSI)

Temperature Range

0°-80°C

Coating

Fusion Bonded Epoxy Coating in accordance with ANSI /AWWA C550

Mounting Flange

305mm / 12" diameter flange for valve mounting,

Mounting flange as per UL262.

Flange Specification

EN 1092-2 , PN16 raised face

Design Standards

BS 5163

Approvals

UL, FM

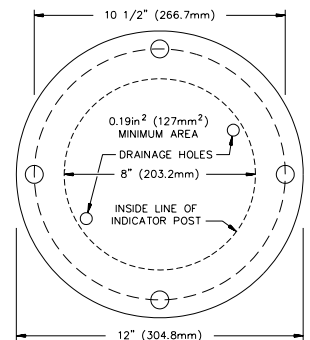

Sizes

| Figure | SIZES | | Dimensions (mm) | | Weight (Kg) | Product Ordering Code |
|---------|-------|--------|-----------------|-----|-------------|-----------------------|
| | Inch | mm | L | H | | |
| 114.1FF | 4" | DN 100 | 229 | 395 | 34.5 | RD114FF100 |
| | 5"* | DN 125 | 254 | 432 | 53.9 | RD114FF125 |
| | 6" | DN 150 | 267 | 475 | 83.7 | RD114FF150 |
| | 8" | DN 200 | 292 | 585 | 86.1 | RD114FF200 |
| 114.2FF | 10" | DN 250 | 330 | 656 | 117.2 | RD114FF250 |
| | 12" | DN 300 | 356 | 751 | 180.0 | RD114FF300 |

*only UL listed



PIV NRS Flanged Gate Valve
BS5163
Fig. 114.1FF / 114.2FF

Installation

Rapidrop Fig. 114FF Flanged Gate Valve is suitable for indoor and outdoor use. The valve should be installed in a location easily accessible for operation and maintenance. The valve may be installed in any position and the flow may be from either direction through the valve. Valves should be supported independently to prevent the movement and stresses from the connecting piping system.

1. Visually inspect the valve, make sure that the connecting flanges are clean of debris and any foreign materials.
2. Ensure that valve is in the closed position during handling and installation process.
3. Insert the valve with appropriate gaskets between the flanges and tighten all flange bolts using the crossover method.
4. After tightening the bolts check the operation by fully opening and closing the valve.
5. Before pressurising the system make sure the valve is in fully open position.

Care and Maintenance

The valve should never be forced to seat by applying a wrench to the stem as this may distort the valve components. The use of excessive force to open or close the valve violates all warranties.

The valve should not be used to force a pipeline into position as this may result in the damage of the valve components.

Rapidrop gate valves require no regular maintenance, however it is advisable to inspect and verify proper operation of the unit annually or in accordance with the authority having jurisdiction.

The inspection should include a visual check for leakage at the pipe connection. Inspection and maintenance should be performed by a competent person in accordance with national codes/ requirements.

Debris in the piping system might cause difficulties in closing the valve, this problem can be overcome by backing off the wrench/ handwheel and closing the valve again.

Rapidrop Figure 114FF Flanged Gate Valves are suitable for both indoor and outdoor use. Minor degradations of surface finish should not affect the performance of the valve.

Recommended Flange Bolt Tightening Torque

| SIZES | | Recommended Minimum Torque |
|-------|--------|----------------------------|
| 4" | DN 100 | 102 Nm |
| 5" | DN 125 | 125 Nm |
| 6" | DN 150 | 149 Nm |
| 8" | DN 200 | 203 Nm |
| 10" | DN 250 | 251 Nm |
| 12" | DN 300 | 305 Nm |

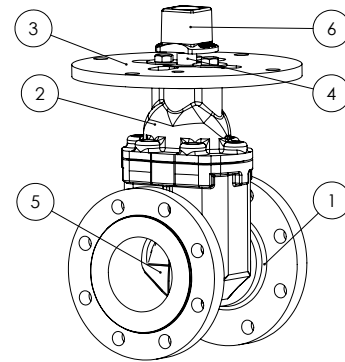

Material Specification

| No | Description | Material |
|----|---------------------------|---------------------|
| 1 | Valve Body | Ductile Iron |
| 2 | Bonnet | Ductile Iron |
| 3 | Indicator Mounting Flange | Ductile Iron |
| 4 | Stem | Stainless Steel |
| 5 | Disc | Ductile Iron + EPDM |
| 6 | Drive Nut | Ductile Iron |

Important Installation Information

- Rapidrop Figure 114FF Flanged Gate Valve must only be installed by a competent person in accordance with requirements of the local authority having jurisdiction. Deviations from these standards will invalidate warranty.
- It is the responsibility of the installing contractor to include a copy of this document in the sprinkler system installation, operating and maintenance manual.
- Alterations to Rapidrop products will void any warranty.
- Figure 114FF Flanged Gate Valve should be inspected and maintained during routine sprinkler system inspections by a competent person in accordance with national codes/requirements.
- Failure to follow these instructions could cause improper operation, resulting in personal injury and/or property damage.
- For further details and technical support please contact your Rapidrop sales representative.