



# PIV NRS Grooved Gate Valve Fig. 114GG

## Product Description

Rapidrop Fig.114GG Valve is a manually operated, non rising stem resilient wedge gate valve designed for use in fire protection systems for on/off operation only. The lightweight ductile iron body allows for easier handling and reduced shipping costs. Valves are suitable for both vertical and horizontal installation. Rapidrop Fig.110 vertical post indicator and Rapidrop Fig.111 wall post indicator, are available separately.

Valve components are corrosion resistant or coated with a thermally applied fusion-bonded epoxy. The EPDM encapsulated ductile iron wedge with a compression mechanism is designed to achieve water tight sealing and low torque operation.

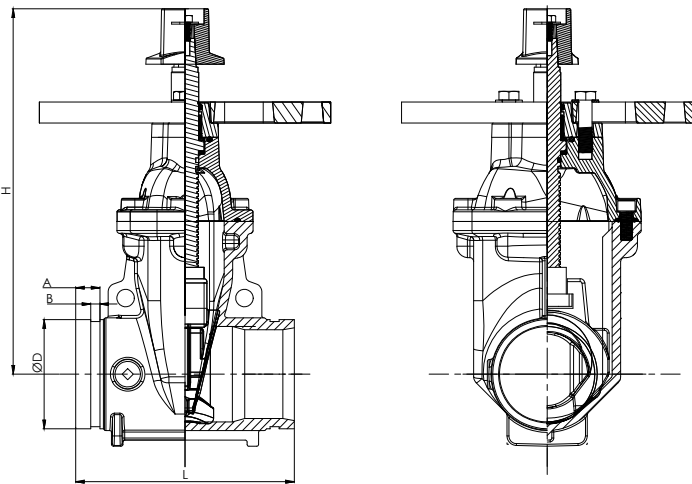
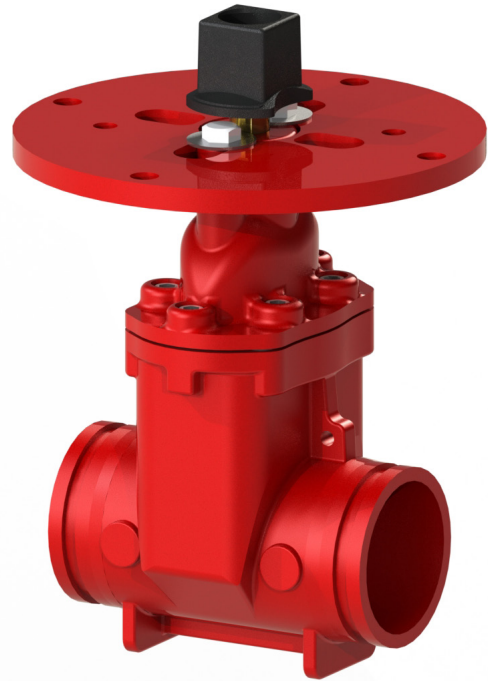

### Maximum Working Pressure

20.7 bar (300 PSI)

### Temperature Range

0°-80°C

### Coating

Fusion Bonded Epoxy Coating in accordance with ANSI /AWWA C550

### Mounting Flange

305mm / 12" diameter flange for valve mounting,

Mounting flange as per UL262.

### Design Standards

AWWA C515

AWWA C606

ISO 6182-12

### Approvals

UL, FM

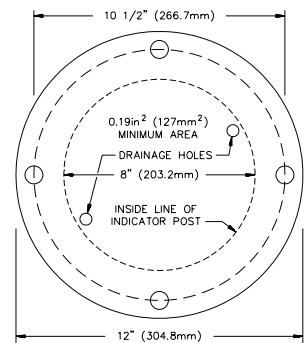

## Sizes

SIZES		Dimensions (mm)					Weight (Kg)	Product Ordering Code
In	mm	L	H	D	A	B		
4"	DN 100	229	395	114.3	15.88	9.52	28.1	RD114GG100
6"	DN 150	267	475	168.3	15.88	9.52	41.8	RD114GG168
8"	DN 200	292	585	219.1	19.05	11.13	68.2	RD114GG200
10"	DN 250	330	656	273.0	19.05	12.70	105.4	RD114GG250
12"	DN 300	356	751	323.9	19.05	12.70	155.9	RD114GG300



## PIV NRS Grooved Gate Valve Fig. 114GG

### Installation

Rapidrop Fig.114GG Grooved Gate Valve is suitable for indoor and outdoor use. The valve should be installed in a location easily accessible for operation and maintenance. The valve may be installed in any position and the flow may be from either direction through the valve. Valves should be supported independently to prevent the movement and stresses from the connecting piping system.

1. Visually inspect the valve, make sure the seating area is not damaged and that the connecting faces are clean of debris and any foreign materials.
2. Ensure that valve is in the closed position during handling and installation process.
3. Using appropriate grooved couplings connect the valve with adjacent pipe or fitting. Follow the instructions supplied by the manufacturer of the couplings.
4. Before pressurising the system make sure the valve is in fully open position.

### Care and Maintenance

The valve should never be forced to seat by applying a wrench to the stem as this may distort the valve components. The use of excessive force to open or close the valve violates all warranties.

The valve should not be used to force a pipeline into position as this may result in the damage of the valve components.

Rapidrop gate valves require no regular maintenance, however it is advisable to inspect and verify proper operation of the unit annually or in accordance with the authority having jurisdiction.

The inspection should include a visual check for leakage at the pipe connection. Inspection and maintenance should be performed by a competent person in accordance with national codes/ requirements.

Debris in the piping system might cause difficulties in closing the valve, this problem can be overcome by backing off the wrench/handwheel and closing the valve again.

Rapidrop Figure 114GG Grooved Gate Valves are suitable for both indoor and outdoor use. Minor degradations of surface finish should not affect the performance of the valve.

### Material Specification

No	Description	Material
1	Valve Body	Ductile Iron
2	Bonnet	Ductile Iron
3	Indicator Mounting Flange	Ductile Iron
4	Stem	Stainless Steel
5	Disc	Ductile Iron + EPDM
6	Drive Nut	Ductile Iron

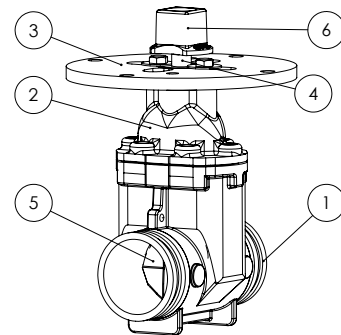

### Important Installation Information

- Rapidrop Figure 114GG Grooved Gate Valve must only be installed by a competent person in accordance with requirements of the local authority having jurisdiction. Deviations from these standards will invalidate warranty.
- It is the responsibility of the installing contractor to include a copy of this document in the sprinkler system installation, operating and maintenance manual.
- Alterations to Rapidrop products will void any warranty.
- Figure 114GG Grooved Gate Valve should be inspected and maintained during routine sprinkler system inspections by a competent person in accordance with national codes/requirements.
- Failure to follow these instructions could cause improper operation, resulting in personal injury and/or property damage.
- For further details and technical support please contact your Rapidrop sales representative.