



Threaded Butterfly Valve Fig. 202

Product Description

Rapidrop Fig. 202 Threaded Butterfly Valve is a rotary type valve with visual indication of whether the valve is in fully open position or not. Butterfly valves are commonly used in fire protection systems as system control valves, sectional or pump water control valves.

These valves have been designed with minimum flow restriction and pressure loss when in fully open position. To reduce the risk of a water hammer Rapidrop Butterfly Valves are provided with a slow close hand wheel operation gearbox.

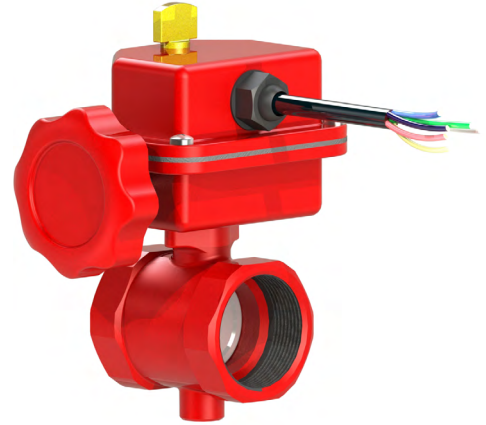
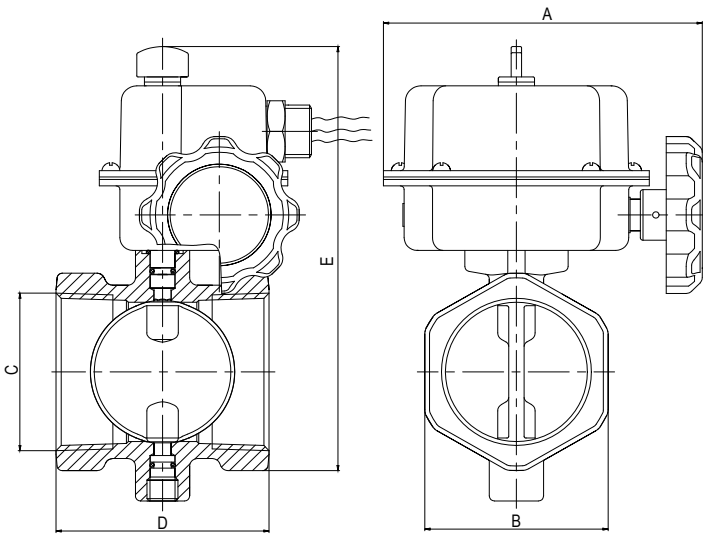

Maximum Working Pressure

12 bar (175 PSI)

Temperature Range

0°-80°C

Coating

Fusion Bonded Epoxy Coating in accordance with ANSI /AWWA C550

Connection Standard

Thread in accordance with ISO7-1

Sizes

SIZES		Dimensions (mm)					Weight (Kg)	Product Ordering Code
Inch	mm	A	B	C(Thread)	D	E		
1"	DN 25	125	41	Rc 1 (1"BSTP)	54	115	1.3	RD202-025
1.25"	DN 32	125	49	Rc 1 1/4 (1 1/4"BSTP)	67	117.5	1.4	RD202-032
1.5"	DN 40	125	55.5	Rc 1 1/2 (1 1/2"BSTP)	73	121	1.5	RD202-040
2"	DN 50	125	71	Rc 2 (2"BSTP)	82.5	131	2.0	RD202-050

Approvals

UL, FM

Switch Installation

An internal, factory installed, double tamper switch with 1m cables provide easy supervision of the valve. Within two handwheel turns from the "OPEN" position the switch will close indicating that the valve is not fully open.

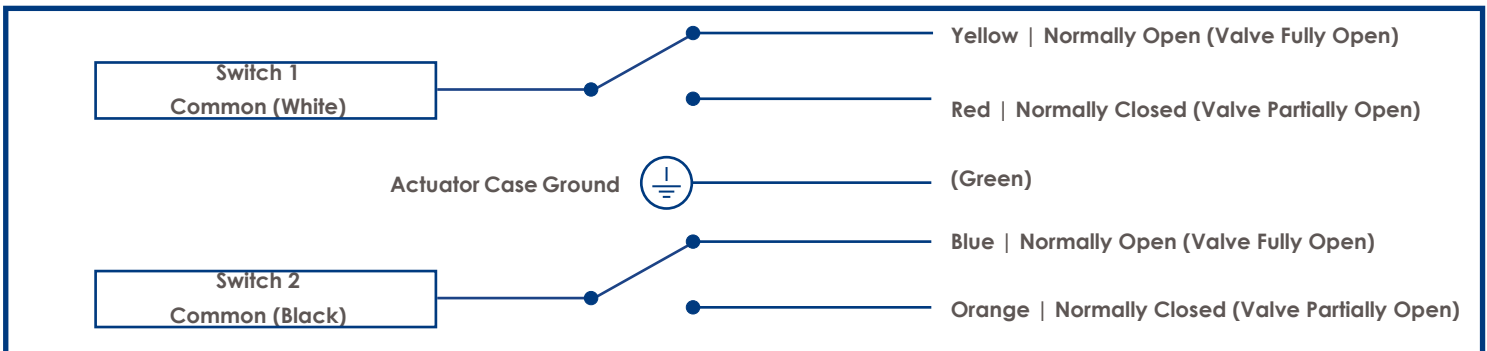



Threaded Butterfly Valve Fig. 202

Installation

Rapidrop Figure 202 Butterfly Valve is suitable for indoor and outdoor use. The valve may be installed in any position and the flow may be from either direction through the valve.

1. Visually inspect the valve, make sure connecting threads are not damaged and clean of debris and any foreign materials.
2. Install the valve using normal sealing and tightening methods for connecting pipe threads. Tighten firmly for leak proof connection.
3. Check the operation by fully opening and closing the valve.

Care and Maintenance

Rapidrop butterfly valves require no regular maintenance, however it is advisable to inspect and verify proper operation of the unit annually or in accordance with the authority having jurisdiction.

The inspection should include a visual check for leakage at the pipe connection and body to gearbox connection. Inspection and maintenance should be performed by a competent person in accordance with national codes/ requirements.

Debris in the piping system might cause difficulties in closing the valve, this problem can be fixed by backing off the handwheel and closing the valve again.

Rapidrop Figure 202 Threaded Butterfly Valve is suitable for both indoor and outdoor use. Minor degradations of surface finish should not affect the performance of the valve.

The valve should never be forced to seat by applying a wrench to the hand wheel as this may distort the valve components or score the sealing surface. The use of excessive force to open or close the valve violates all warranties.

The valve should not be used to force a pipeline into position as this may result in the distortion of the valve body.

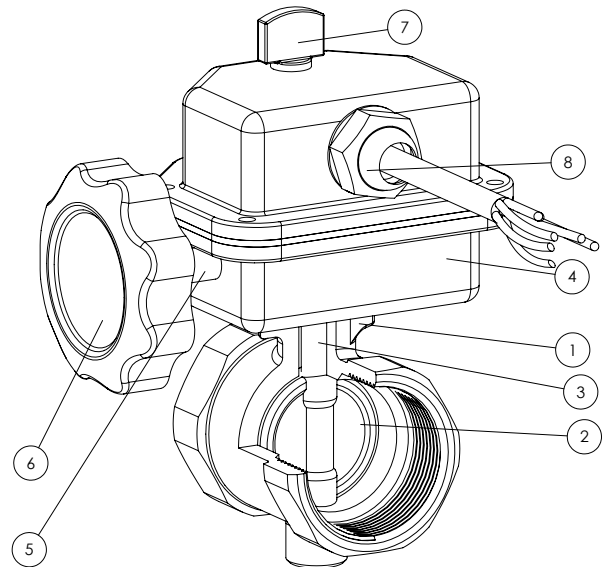

Material Specification

No	Description	Materials
1	Valve Body	Ductile Iron
2	Disc	Carbon Steel + EPDM
3	Stem	Stainless Steel
4	Gearbox	Carbon Steel
5	Handwheel Shaft	SS431
6	Handwheel	Ductile Iron
7	Indicator	Ductile Iron
8	Cable Gland	Plastic

Important Installation Information

- Rapidrop Figure 202 Threaded Butterfly Valves must only be installed by a competent person in accordance with requirements of the local authority having jurisdiction. Deviations from these standards will invalidate warranty.
- It is the responsibility of the installing contractor to include a copy of this document in the sprinkler system installation, operating and maintenance manual.
- Alterations to Rapidrop products will void any warranty.
- Figure 202 Threaded Butterfly Valves should be inspected and maintained during routine sprinkler system inspections by a competent person in accordance with national codes/requirements.
- Failure to follow these instructions could cause improper operation, resulting in personal injury and/or property damage.
- For further details and technical support please contact your Rapidrop sales representative.